

PROFILE VIEW

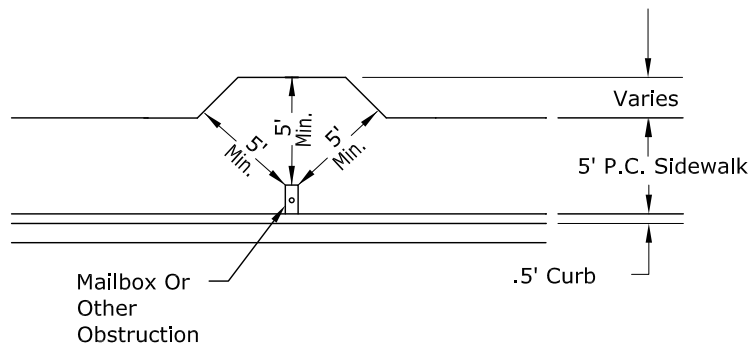

PLAN VIEW

Notes:

1. Use This Detail For All Sidewalk Obstructions Including Mailboxes, Light Poles, Utility Poles, Etc.
2. Maintain Minimum 5' Clear Zone Around All Obstacles.
3. Install Mailboxes In Accordance With ODOT Standard Drawings.
4. Permanent Location Of Mailboxes To Be Determined By The U.S. Postal Service
5. Face Of Mailboxes To Be Mounted Flush With The Back Of Curb.
6. An Easement Or Right-of-Way Dedication May Be Required If Apron Extends Onto Private Property.



WASHINGTON COUNTY
DEPARTMENT OF LAND USE &
TRANSPORTATION
ENGINEERING SECTION

TYPICAL SIDEWALK OBSTRUCTION
SWING-AWAY APRON

PLOT STAMP: 02/24/11 5:47P KELLYE
CAD: 2120.DWG

EFFECTIVE DATE: 3/18/2011

WASH. CO. # 2120