

North Bethany *Main Street*



Parking & Loading

Explanation:

Vehicle access is often in conflict with pedestrian-friendly design. To promote a safe, comfortable, and vibrant pedestrian environment, it's best to limit driveway curb-cuts and surface parking adjacent to sidewalks. Parking and loading should be located behind buildings to the greatest extent possible.



Parking Recommendation:

- Priority 1 Streets:
 - Parking not allowed between the building and sidewalk.
 - No driveway access.
- Priority 2 Streets:
 - Parking allowed to side of building.
 - Max. one driveway per block.

Loading Recommendation:

Buildings with surface parking: loading area needs to be screened from the ROW, and should not interfere with pedestrian circulation.

Buildings with structured parking: loading area must be internal to building; accessed from Priority 2 or non-priority street.

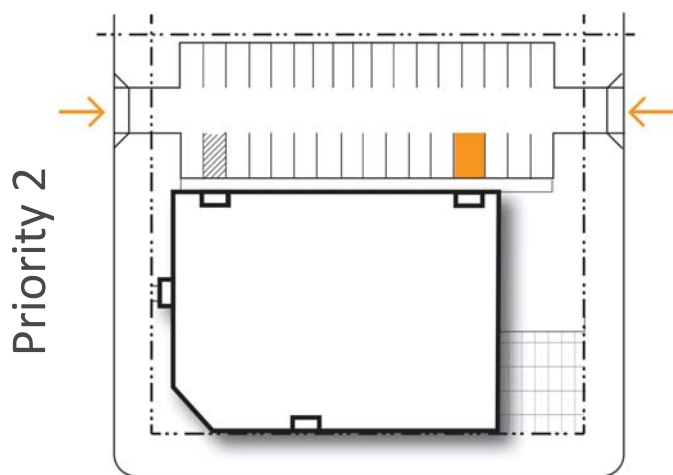

Priority 1



Parking and loading behind building



Internal loading area for building with structured parking