

WASHINGTON COUNTY, OREGON
DEPARTMENT OF LAND USE AND TRANSPORTATION



PLANS FOR PROPOSED PROJECT

GRADING, DRAINAGE, PAVING, STRUCTURES

NW 143RD AVENUE PEDESTRIAN PATH

WASHINGTON COUNTY
 SPRING 2011



INDEX OF SHEETS	
SHEET NO.	DESCRIPTION
1	TITLE SHEET
1A	PROJECT SHEET LAYOUT
2 thru 2A	TYPICAL SECTIONS
2B thru 2B-2	CONSTRUCTION DETAILS
3 thru 5	CONSTRUCTION PLAN

General Notes:

1. It Is The Responsibility Of The Contractor To Obtain All Necessary Utility Locates Prior To Excavation And Coordinate Any Logistical Requirements With The Utility Companies And Washington County.
2. Any Item Damaged During Construction To Be Replaced Or Repaired, In Kind, At The Discretion Of The Engineer And At The Expense Of The Contractor.
3. Illustrated Information Is Based On Data Acquired From Aerial Photographs and Field Measurements.

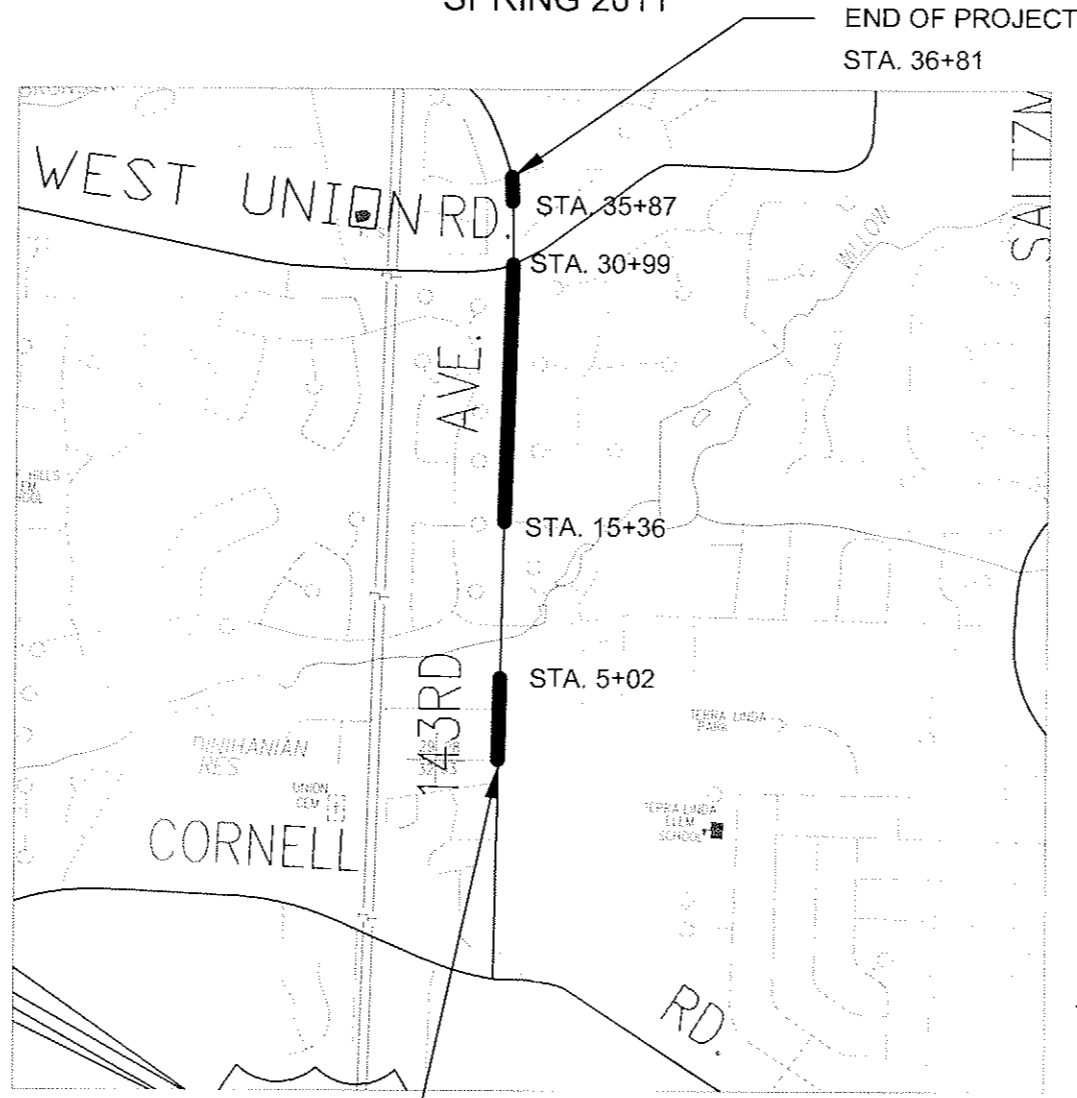
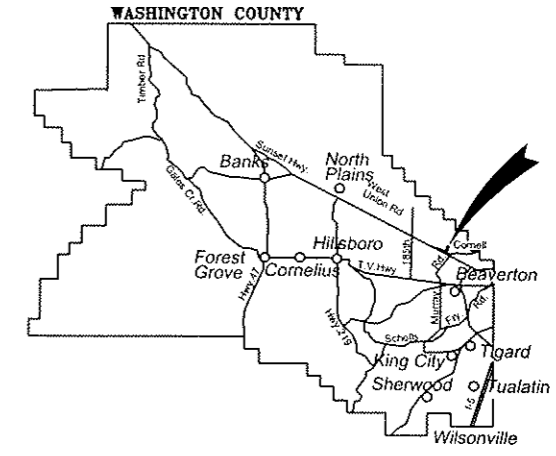

Contact Information

- Greg Clemmons, P.E. - Principal Engineer - 503-846-7653
- Todd Watkins, P.E. - Senior Engineer - 503-846-7650
- Aaron Clodfelter, E.I.T. - Designer - 503-846-7632
- Ted Voelker - Technician - 503-846-7647
- Janet Oatney - Environmental Services - 503-846-7652

ATTENTION:
 Oregon Law Requires You To Follow Rules
 Adopted By The Oregon Utility Notification Center.
 Those Rules Are Set Forth In OAR 952-001-0010 Through
 OAR 952-001-0090. You May Obtain Copies Of The Rules From The Center.



SEC. 28
 T. 1 N., R. 1 W., W. M.



BEGINNING OF PROJECT
 STA. 00+00

END OF PROJECT
 STA. 36+81

PROJECT MAP
 NO SCALE

DEPARTMENT OF
 LAND USE &
 TRANSPORTATION
 OPERATIONS

PLOT STAMP: 03/28/11 8:46A TEDY	NO. REVISIONS
CAD: 7569_COMPLETE_TITLE_TOP_SHEETS.DWG, TAB: TITLE PAGE	

NW 143RD AVENUE
 0.1 MI. S. OF HUNTERS DR TO WEST UNION RD
 WASHINGTON COUNTY

TITLE SHEET

PROJECT NUMBER 7569
SHEET NO. 1 OF 10
SHEET TITLE 1

PROJECT SHEET LAYOUT

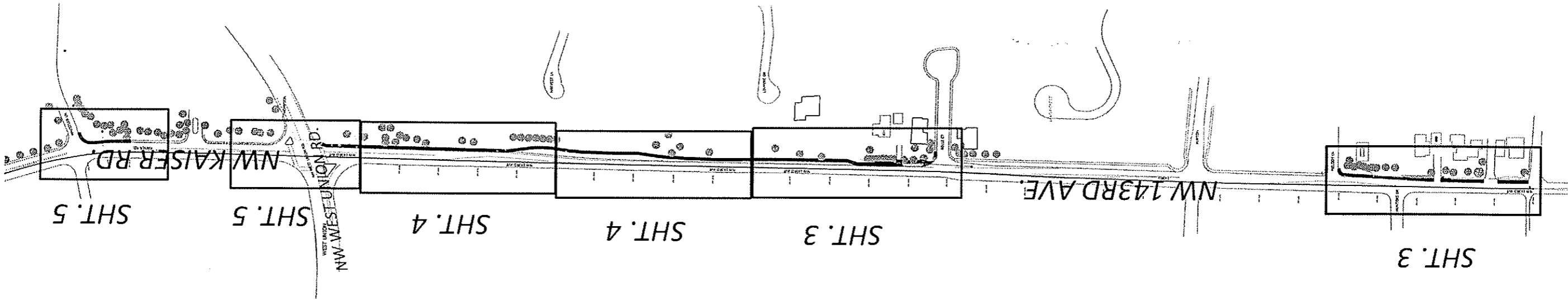

Note:
 The Purpose Of This Sheet Is To Show The Full Project, As Well As Document Roadway Plan Sheet Organization.

- 2008 ODOT Drawings Herein Made A Part Of These Plans.
- TM700 - TCP Details
 - TM710 - TCP Details
 - TM775 - Temporary Signs
 - TM750 - Barricade
 - RD100 - Mailbox Support
 - RD101 - Mailbox Installation
 - RD300 - Trench Backfill, Bedding, Pipe Zone...
 - RD700 - Curbs
 - RD720 - Sidewalks
 - RD757 - Sidewalk Ramp Placement Options Curb Radii > 15'
 - RD759 - Truncated Dome Detectable Warning Surface
 - RD1005 - Check Dams
 - RD1010 - Inlet Protection (Type 1, 2 and 3)
 - RD1015 - Inlet Protection (Type 4) Biofilter Bags
 - RD1025 - Sediment Barrier (Type 1)
 - RD1030 - Sediment Barrier (Type 2 and 4 biofilter or sand bags)
 - RD1035 - Sediment Barrier (Type 3)
 - RD1040 - Sediment Fence
 - RD1055 - Matting

NO. REVISIONS

NO.	REVISIONS

PROJECT SHEET LAYOUT

0.1 MI. S. OF HUNTERS DR TO WHISTLER LN
 WASHINGTON COUNTY

NW 143RD AVENUE

PROJECT NUMBER
 7569

SHEET NO.
 2 OF 10

SHEET TITLE
 1A

WASHINGTON COUNTY
 OREGON

DEPARTMENT OF
 LAND USE &
 TRANSPORTATION
 OPERATIONS

REGISTERED PROFESSIONAL ENGINEER
 52807PE

TODD A. WATKINS
 JULY 9, 2007
 OREGON

EXPIRES 6-30-12

TYPICAL SECTIONS

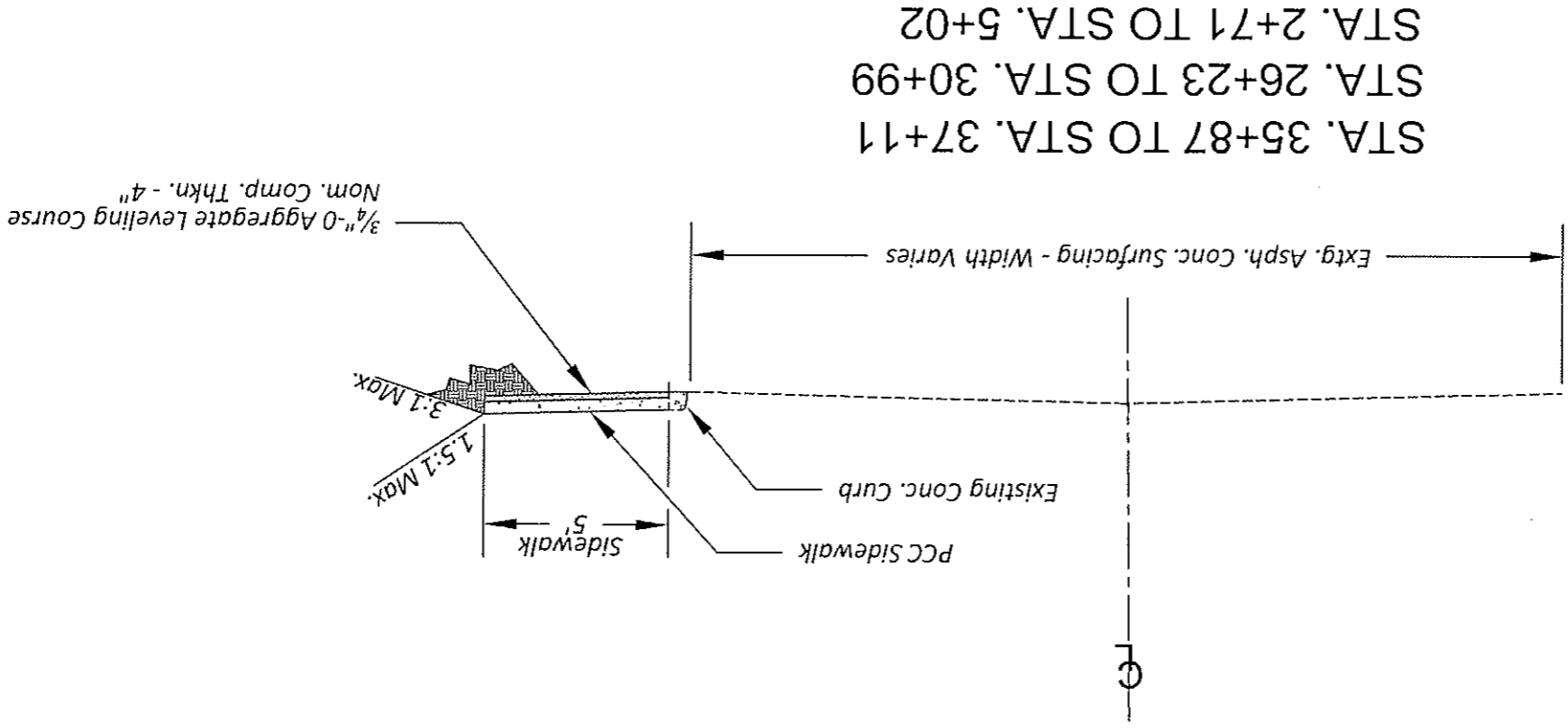

STA. 35+87 TO STA. 37+11
 STA. 26+23 TO STA. 30+99
 STA. 2+71 TO STA. 5+02

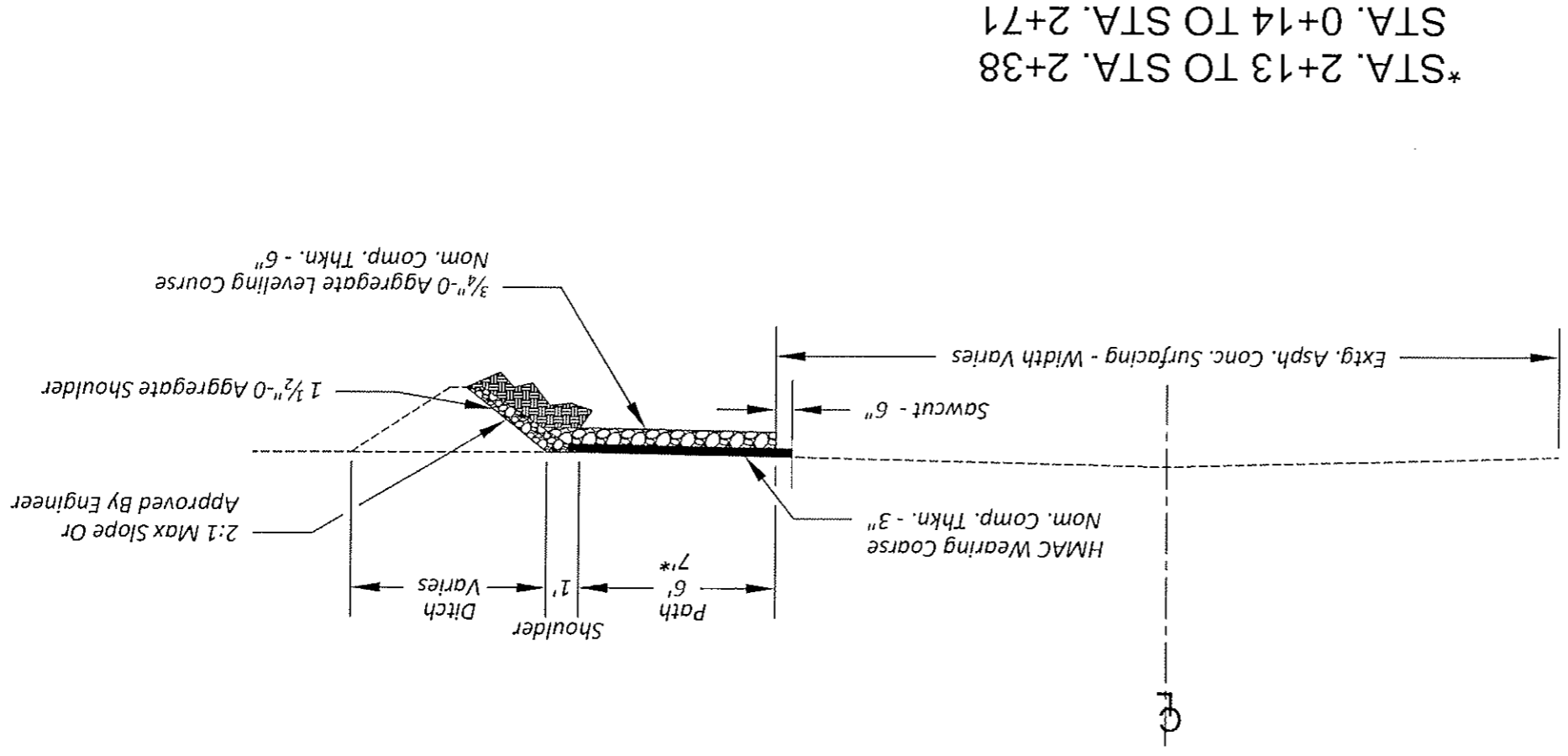

*STA. 2+13 TO STA. 2+38
 STA. 0+14 TO STA. 2+71

TYPICAL SECTIONS

NW 143RD AVENUE
 0.1 MI. S. OF HUNTERS DR TO WHISTLER LN
 WASHINGTON COUNTY

PROJECT NUMBER
 7569

SHEET NO.
 3 OF 10

SHEET TITLE
 2

PILOT STAMP: 02/11/11 9:12A AARONC
 CAD: DESIGN DRAWINGS RESIZED.DWG TAB: SECTIONS 1

NO. REVISIONS



DEPARTMENT OF
 LAND USE &
 TRANSPORTATION
 OPERATIONS

EXPIRES 6-30-12

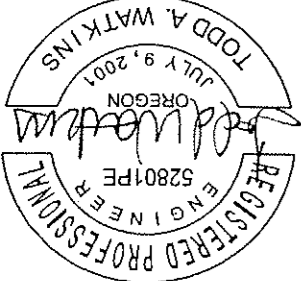

TYPICAL SECTIONS

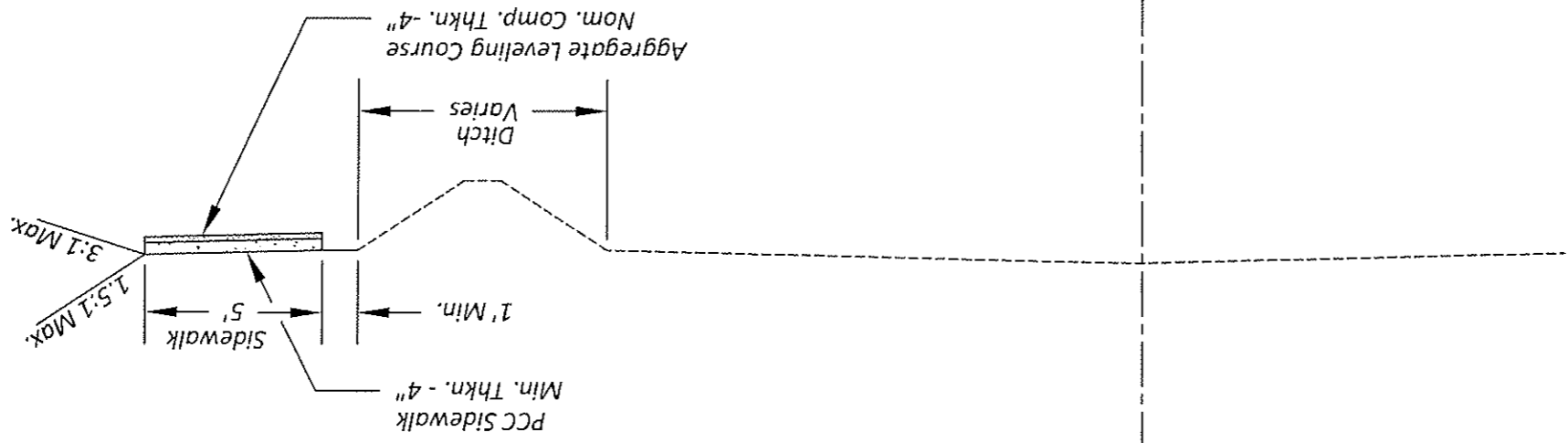

STA. 17+59 TO STA. 26+23

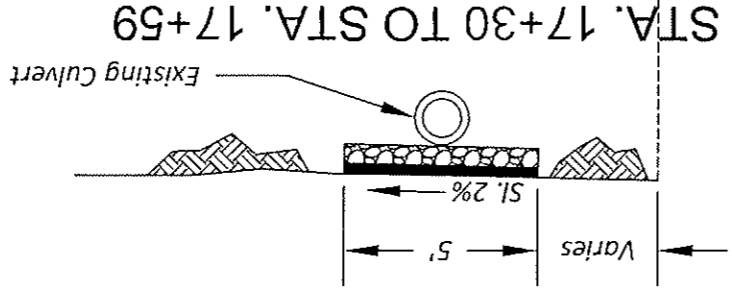

STA. 17+30 TO STA. 17+59

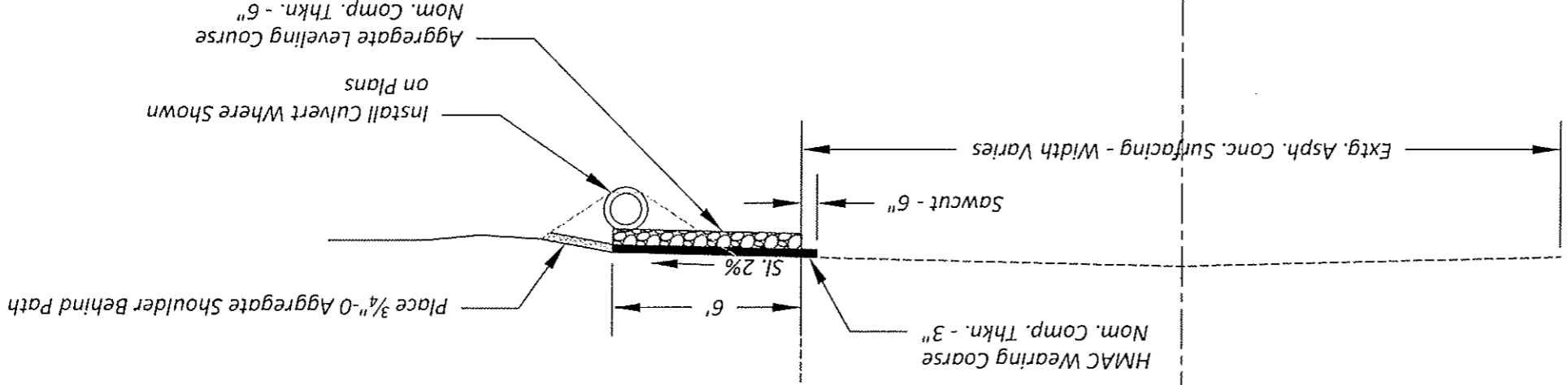

STA. 16+32 TO STA. 17+30

TYPICAL SECTIONS

NW 143RD AVENUE
 0.1 MI. S. OF HUNTERS DR TO WHISTLER LN
 WASHINGTON COUNTY

PROJECT NUMBER
7569
 SHEET NO.
4 OF **10**
 SHEET TITLE
2A

PLOT STAMP: 02/11/11 9:12A AARONC
 CAD: DESIGN DRAWINGS RESZLDMG, TAB: SECTIONS 2

NO. REVISIONS



DEPARTMENT OF
 LAND USE &
 TRANSPORTATION
 OPERATIONS

EXPIRES 6-30-12



CONSTRUCTION DETAILS

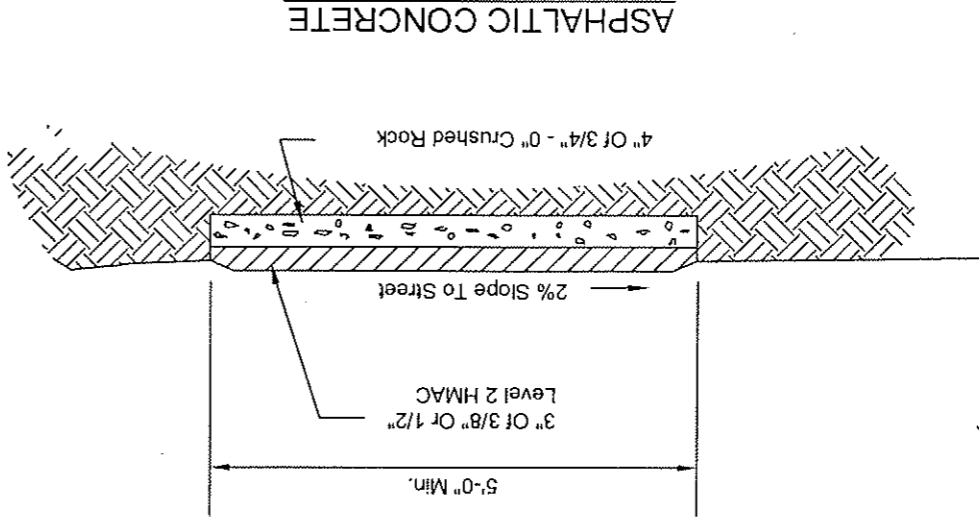
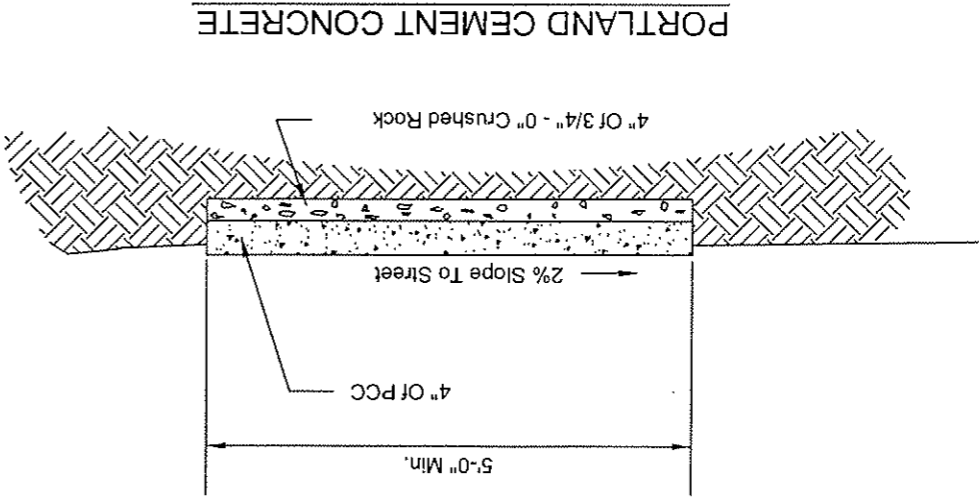
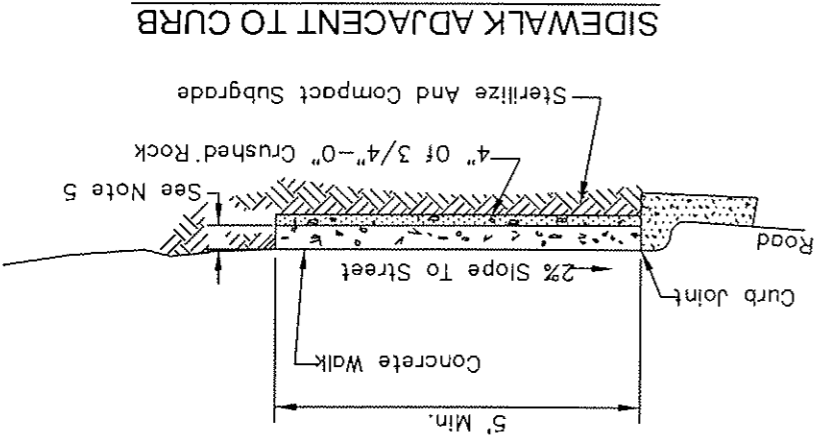

- NOTES:
1. Concrete Shall Be Commercial Grade Concrete Per Section 00440.
 2. P.C. Concrete Panels Shall Be Square, Deep Cut Contraction Joints At 5 Foot Intervals, Edged On 4 Sides And Have A Light Broom Finish.
 3. In Both Cases Sterilize And Compact Subgrade.

- NOTES:
1. Concrete Shall Be Commercial Grade Concrete Per Section 00440.
 2. Panel Dimensions To Be Nominal 5 Feet Or As Directed By Engineer. Perimeters Of Each Panel Shall Be Trowel Finished (shined). All Panels Shall Have A Broom Finish.
 3. Expansion Joints To Be Placed Adjacent To Driveway Approaches, Utility Vaults, Drainage Inlets, Sidewalk Ramps, Curb Joints And At Spacing Not To Exceed 200 Feet.
 4. Sidewalk Edges Shall Be Troweled With A Minimum 1/2" Radius.
 5. Sidewalk Shall Have A Minimum Thickness Of 6 Inches If Sidewalk Is Intended As Portion Of Driveway. Otherwise Sidewalk Shall Have Minimum Thickness Of 4 Inches.
 6. Drain Blockouts In Curbs Shall Be Extended To Back Of Sidewalk With 3" Dia. Plastic Pipe At 2% Slope. Construction Joint To Be Placed Over Pipe.
 7. At Each CG-30 And CG-48 Inlet Location, Place A 10 Ft. Long #4 Bar Centered Between Back Of The Inlet Structure And Back Of Walk. Install Joints And Rebar At Direction Of Engineer.

CONSTRUCTION DETAILS

NW 143RD AVENUE
0.1 MI. S. OF HUNTERS DR TO WHISTLER LN
WASHINGTON COUNTY

PROJECT NUMBER
7569

SHEET NO.
5 OF 10
SHEET TITLE
2B

PLOT STAMP: 02/11/11 9:13A AARONC
CAD: DESIGN DRAMMIS RESIZEDWG, TAB: DETAILS (3)

NO. REVISIONS



DEPARTMENT OF
LAND USE &
TRANSPORTATION
OPERATIONS



VEGETATION CLEARING DETAIL

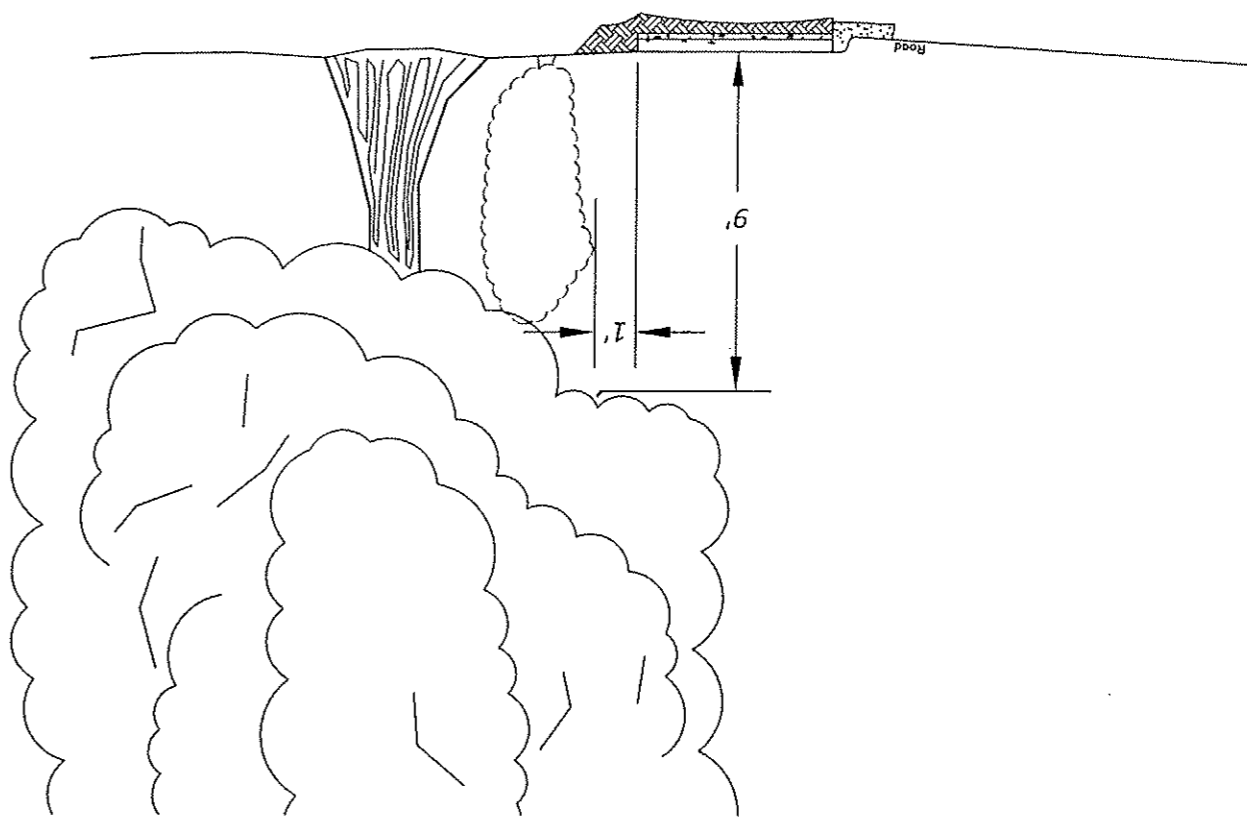

MAILBOX INSTALLATION PLAN

SINGLE OR DOUBLE SUPPORT

SEE ODOT STD. DWG. NO. RD100 & RD101 FOR DETAILS AND NOTES.

SIDE VIEW FRONT VIEW

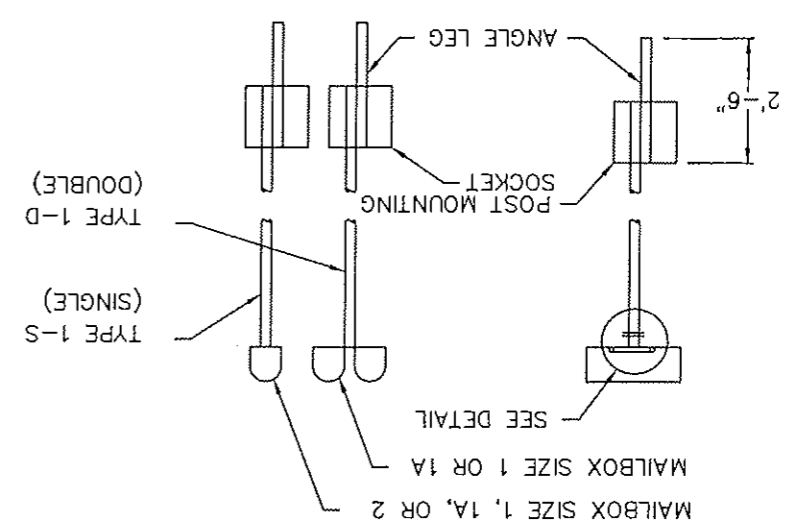

PIPE BEDDING AND BACKFILL DETAILS

- NOTE:
1. Minimum Backfill Compaction Requirements: Top 3' Of Backfill, 95% Of T-99; Below 3', 90% Of T-99.
 2. After Backfill And T-Cut Patch, A Mill And Fill 2" Thick May Be Required To Maintain The Travel Lane Integrity.
 3. Restore With Design Or Existing Road Structural Section.

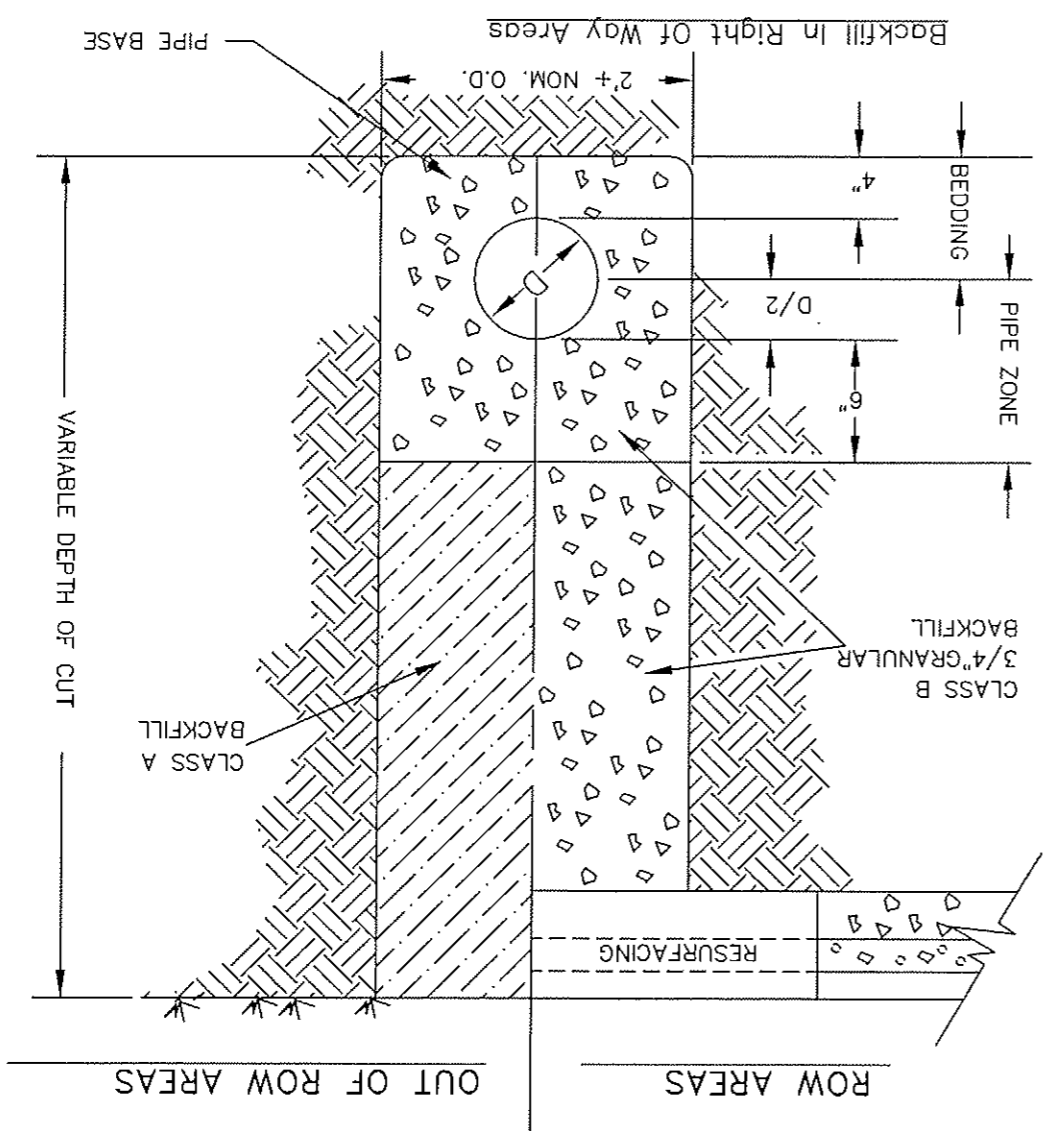

CONSTRUCTION DETAILS

CONSTRUCTION DETAILS
 NW 143RD AVENUE
 0.1 MI. S. OF HUNTERS DR TO WHISTLER LN
 WASHINGTON COUNTY

PROJECT NUMBER
 7569
 SHEET NO.
 6 OF 10
 SHEET TITLE
 2B-2

DEPARTMENT OF
 LAND USE &
 TRANSPORTATION
 OPERATIONS
 WASHINGTON COUNTY
 OREGON

REGISTERED PROFESSIONAL
 ENGINEER
 52801PE
 TODD A. WATKINS
 JULY 9, 2001
 EXPIRES 6-30-12

CONSTRUCTION DETAILS

TRUNCATED DOME DETAIL

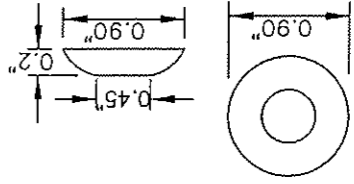

RAMP TEXTURE PATTERN DETAIL

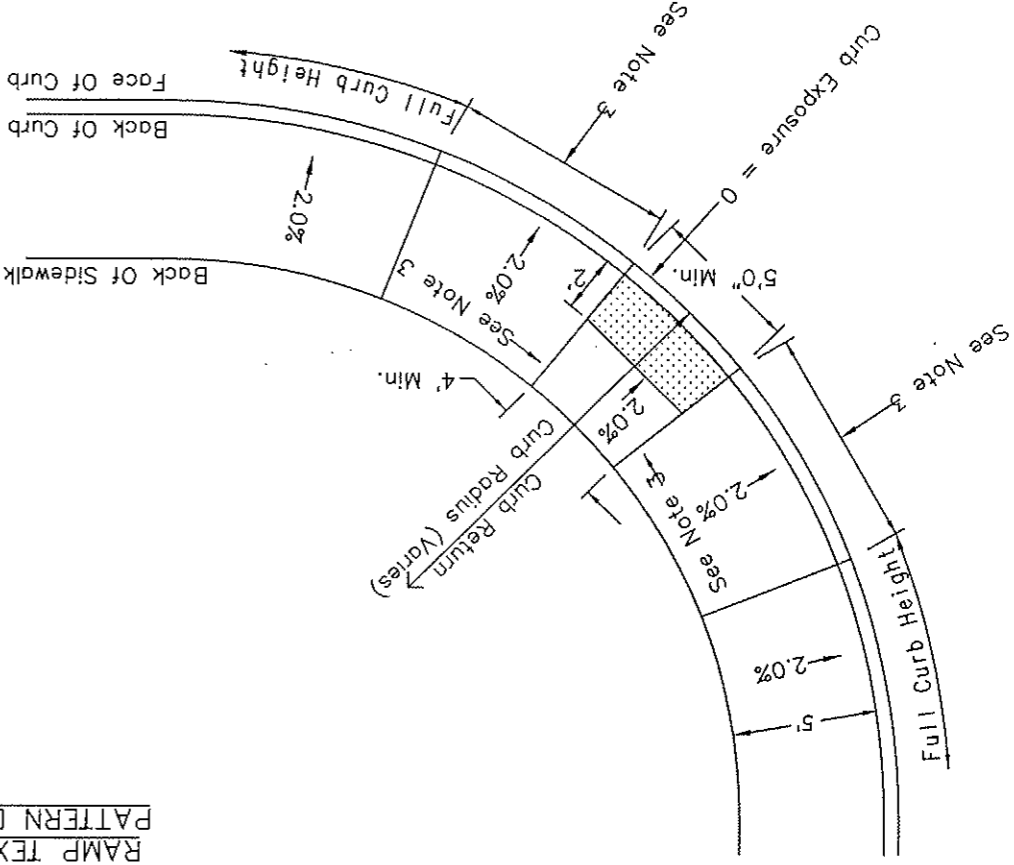
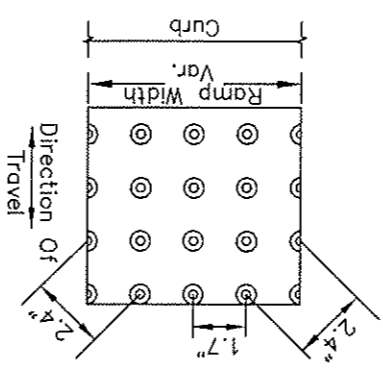

- NOTES:
- 1) Place Truncated Dome Detectable Warning Texture in The Lower 24" Of The Throat Of The Ramp Only. Arrange Domes Using In-line Pattern Only As Shown in Detail Right. Color Of Texture To Be Safety Yellow. For Construction Of Sidewalk Ramps Outside Of Public Right-of-Way, Check With State Building Codes.
 - 2) For Alternate Curb Ramp Designs See Oregon Standard Drawings. Alternate Curb Ramp Designs Requires The County Engineer's Approval.
 - 3) The Curb Ramp Sidewalk Wing Slopes Shall Not Be Steeper Than 12H:1V Relative To The Horizontal Plane And The Longitudinal Length Of The Wings Shall Be A Minimum Of 3' To A Maximum Of 15'.

ASPHALT CONCRETE SIDEWALK RAMP

CURB ELEVATION B-B

N.T.S.

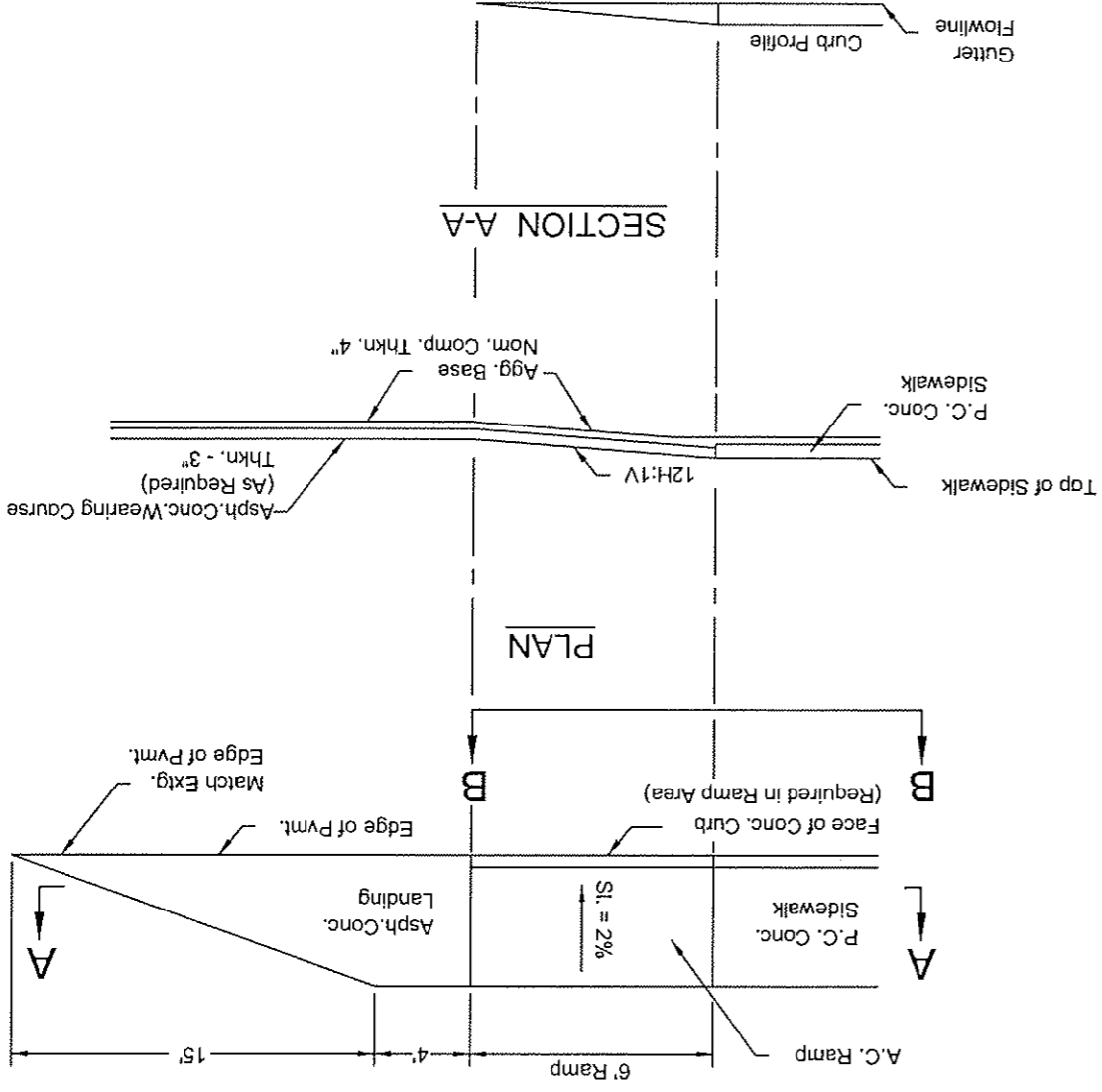

CONSTRUCTION DETAILS

NW 143RD AVENUE
0.1 MI. S. OF HUNTERS DR TO WHISTLER LN
WASHINGTON COUNTY

PROJECT NUMBER 7569

SHEET NO. 7 OF 10

SHEET TITLE 2B-3

NO. REVISIONS

PLCOT STAMP: 02/11/11 9:13A AARONC
CAD: DESIGN DRAMMOS RESIZEDWG, TAB: DETAILS

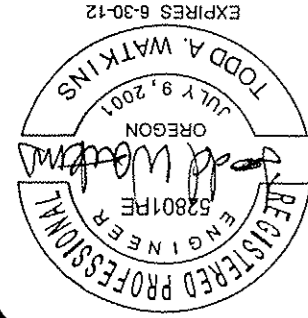

CONSTRUCTION PLAN

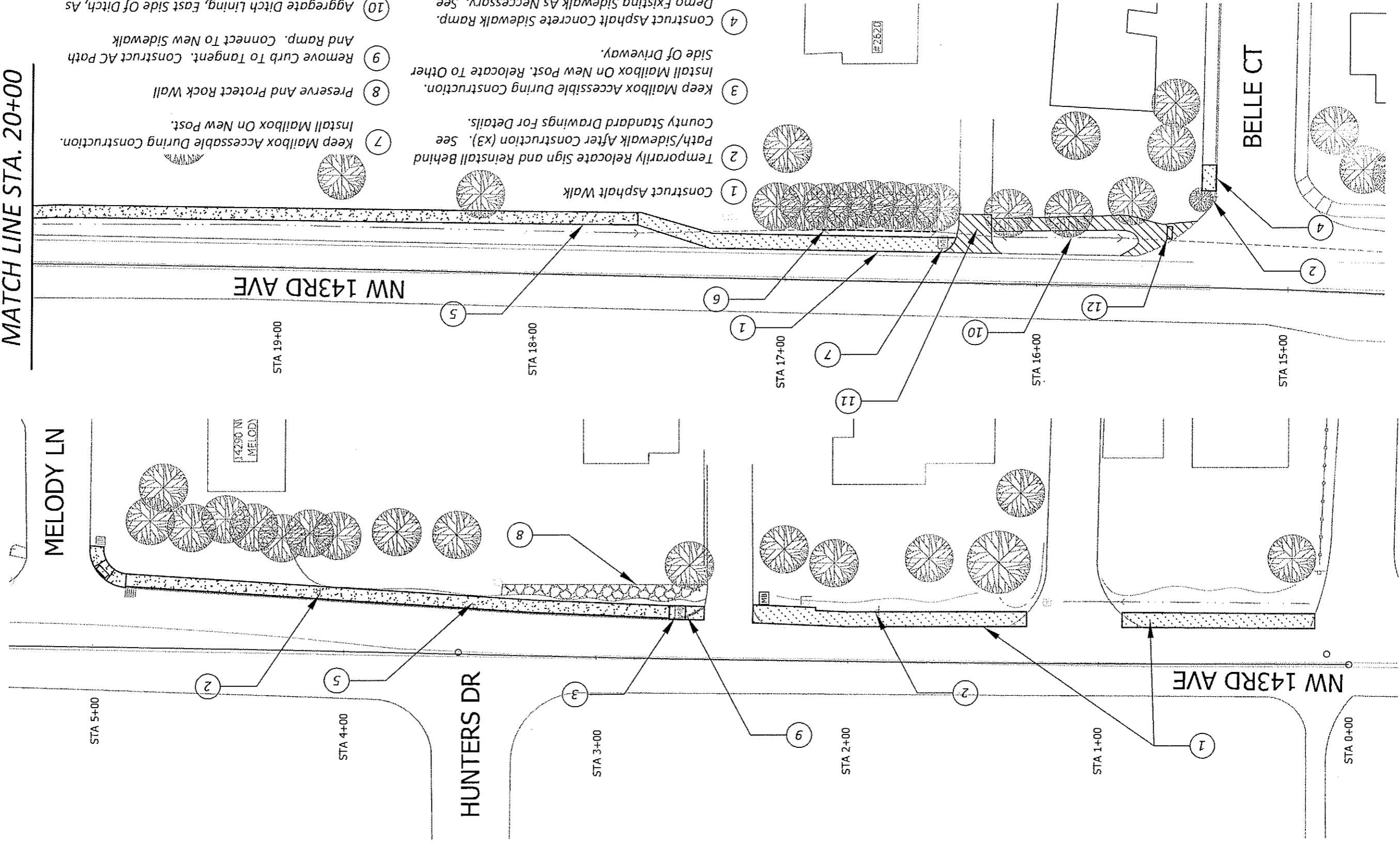

MATCH LINE STA. 20+00

- 1 Construct Asphalt Walk
- 2 Temporarily Relocate Sign and Reinstall Behind Path/Sidewalk After Construction (x3). See County Standard Drawings For Details.
- 3 Keep Mailbox Accessible During Construction. Install Mailbox On New Post. Relocate To Other Side Of Driveway.
- 4 Construct Asphalt Concrete Sidewalk Ramp. Demo Existing Sidewalk As Necessary. See Sheet 28-3.
- 5 Construct Concrete Walk
- 6 Install 12" Concrete Culvert - 45'. Connect To Existing Pipes. Special Connection Required
- 7 Keep Mailbox Accessible During Construction. Install Mailbox On New Post.
- 8 Preserve And Protect Rock Wall
- 9 Remove Curb To Tangent. Construct AC Path And Ramp. Connect To New Sidewalk
- 10 Aggregate Ditch Lining, East Side Of Ditch, As Directed.
- 11 Overlay Existing Path And Driveway With 1.5" HMAc. Taper All Joints.
- 12 Install 6' x 2' Truncated Dome Detectable Warning Surface.

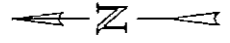
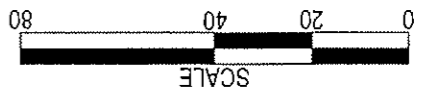

NW 143RD AVENUE
0.1 MI. S. OF HUNTERS DR TO WHISTLER LN
WASHINGTON COUNTY

CONSTRUCTION PLAN

PROJECT NUMBER
7569

SHEET NO.
8 OF **10**

SHEET TITLE
3

PLAT STA: 02/11/11 9:13A AARONC
CAD: DESIGN DRAWINGS RESIZED, DWG. TAB: PLAN 1

NO.	REVISIONS

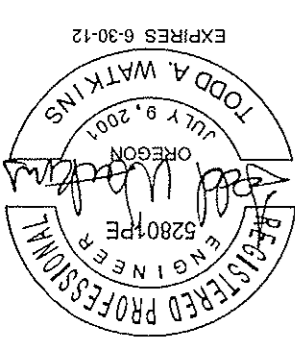

CONSTRUCTION PLAN

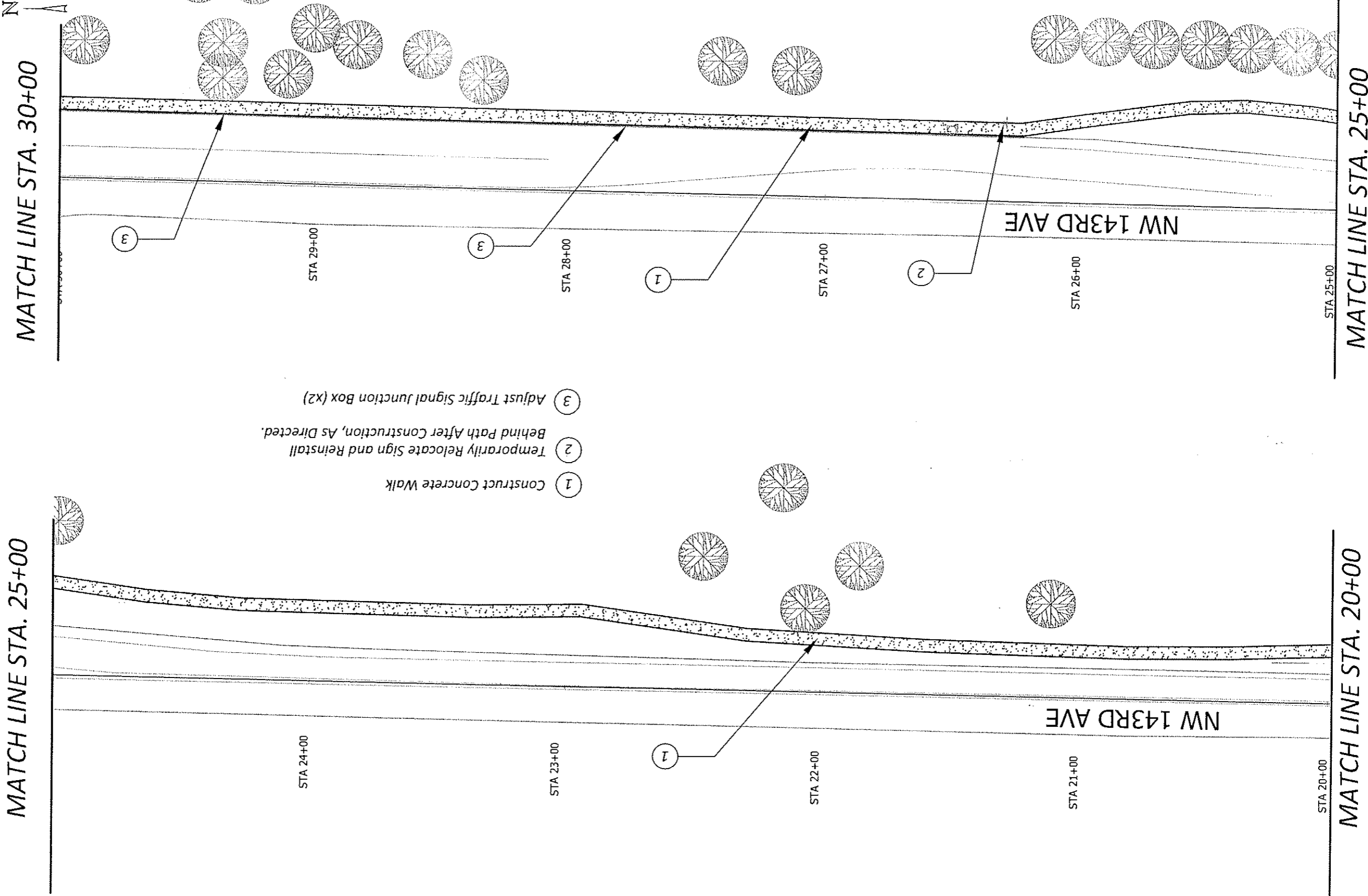

- ① Construct Concrete Walk
- ② Temporarily Relocate Sign and Reinstall Behind Path After Construction, As Directed.
- ③ Adjust Traffic Signal Junction Box (x2)

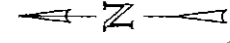
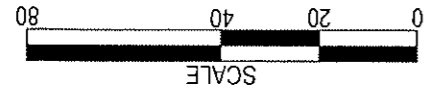

PROJECT NUMBER
7569

SHEET NO.
9 OF **10**

SHEET TITLE
4

CONSTRUCTION PLAN

NW 143RD AVENUE
0.1 MI. S. OF HUNTERS DR TO WHISTLER LN
WASHINGTON COUNTY

PILOT STAMP: 02/11/11 9:13A AARONC
CAD: DESIGN DRAWINGS RESIZEDWG, TAB: PLAN 2

NO.	REVISIONS

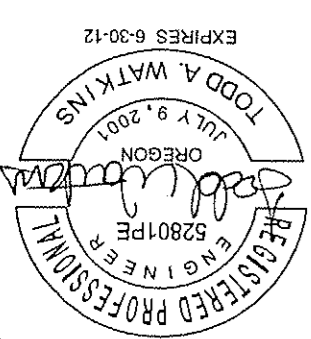
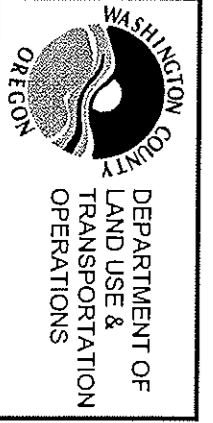

MATCH LINE STA. 25+00

MATCH LINE STA. 20+00

MATCH LINE STA. 30+00

MATCH LINE STA. 25+00

NW 143RD AVE

NW 143RD AVE

STA 29+00

STA 28+00

STA 27+00

STA 26+00

STA 25+00

STA 24+00

STA 23+00

STA 22+00

STA 21+00

STA 20+00

CONSTRUCTION PLAN

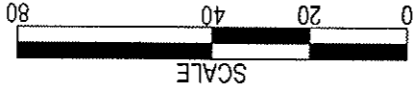
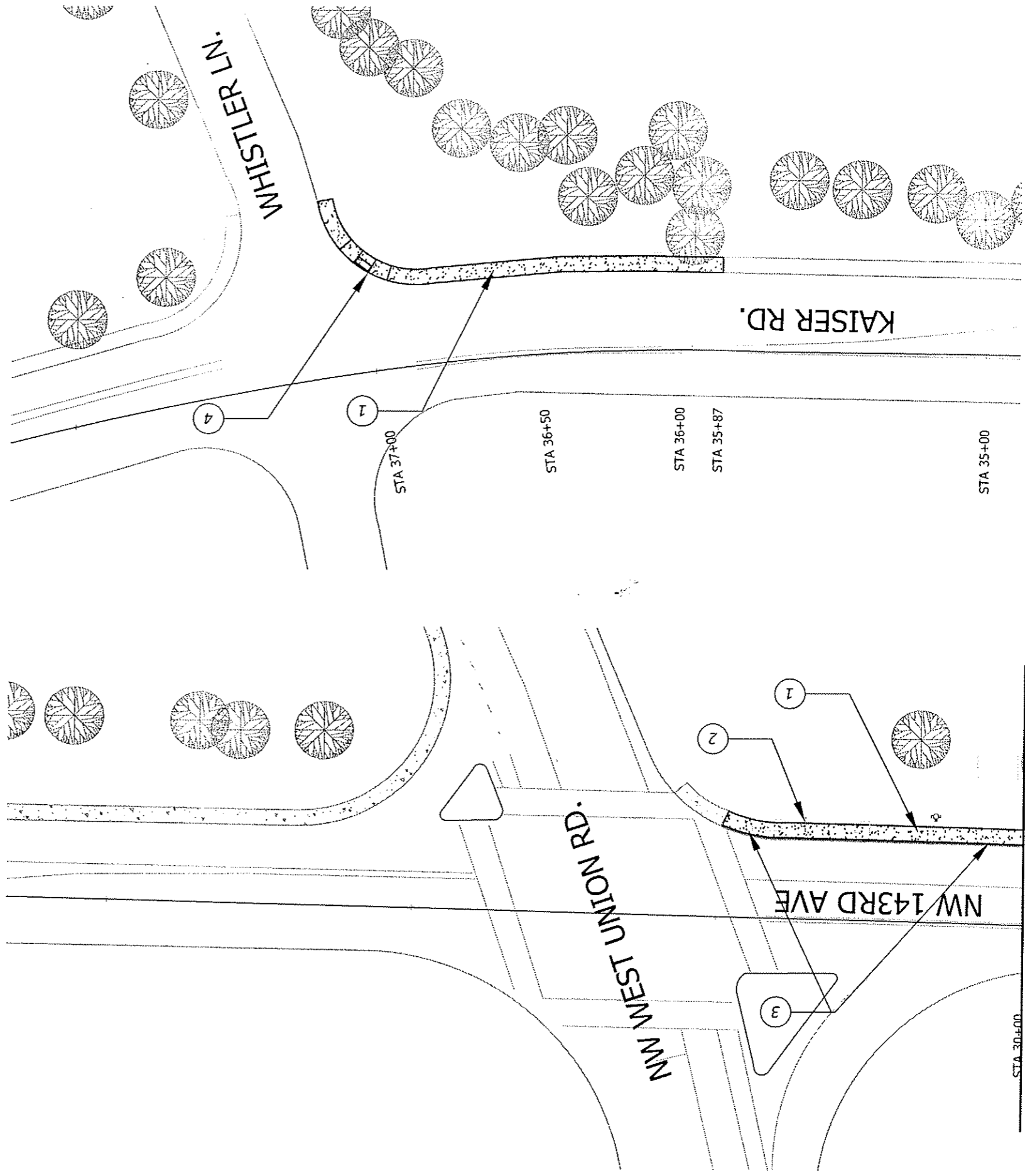

- ① Construct Concrete Walk.
- ② Reinstall Sign Behind Path After Construction, As Directed
- ③ Adjust Traffic Signal Junction Box (x2)
- ④ Construct Curb Ramp.

<p>PROJECT NUMBER 7569</p> <p>SHEET NO. 10 OF 10</p> <p>SHEET TITLE 5</p>	<p>NW 143RD AVENUE 0.1 MI. S. OF HUNTERS DR TO WHISTLER LN WASHINGTON COUNTY</p> <p>CONSTRUCTION PLAN</p>								
<p>PLLOT STAMP: 02/11/11 9:13A AARONC CAD: DESIGN DRAWINGS RESIZE.DWG, TAB: PLAN 3</p>	<p>DEPARTMENT OF LAND USE & TRANSPORTATION</p> <p>WASHINGTON COUNTY OREGON</p>								
<p>REGISTERED PROFESSIONAL ENGINEER 52801PE</p> <p>TODD A. WATKINS JULY 9, 2001 EXPIRES 6-30-12</p>	<p>NO. REVISIONS</p> <table border="1" style="width: 100%; border-collapse: collapse;"> <tr><td style="width: 20px;"> </td><td style="width: 20px;"> </td></tr> <tr><td> </td><td> </td></tr> <tr><td> </td><td> </td></tr> <tr><td> </td><td> </td></tr> </table>								