

SW MILLER HILL RD.

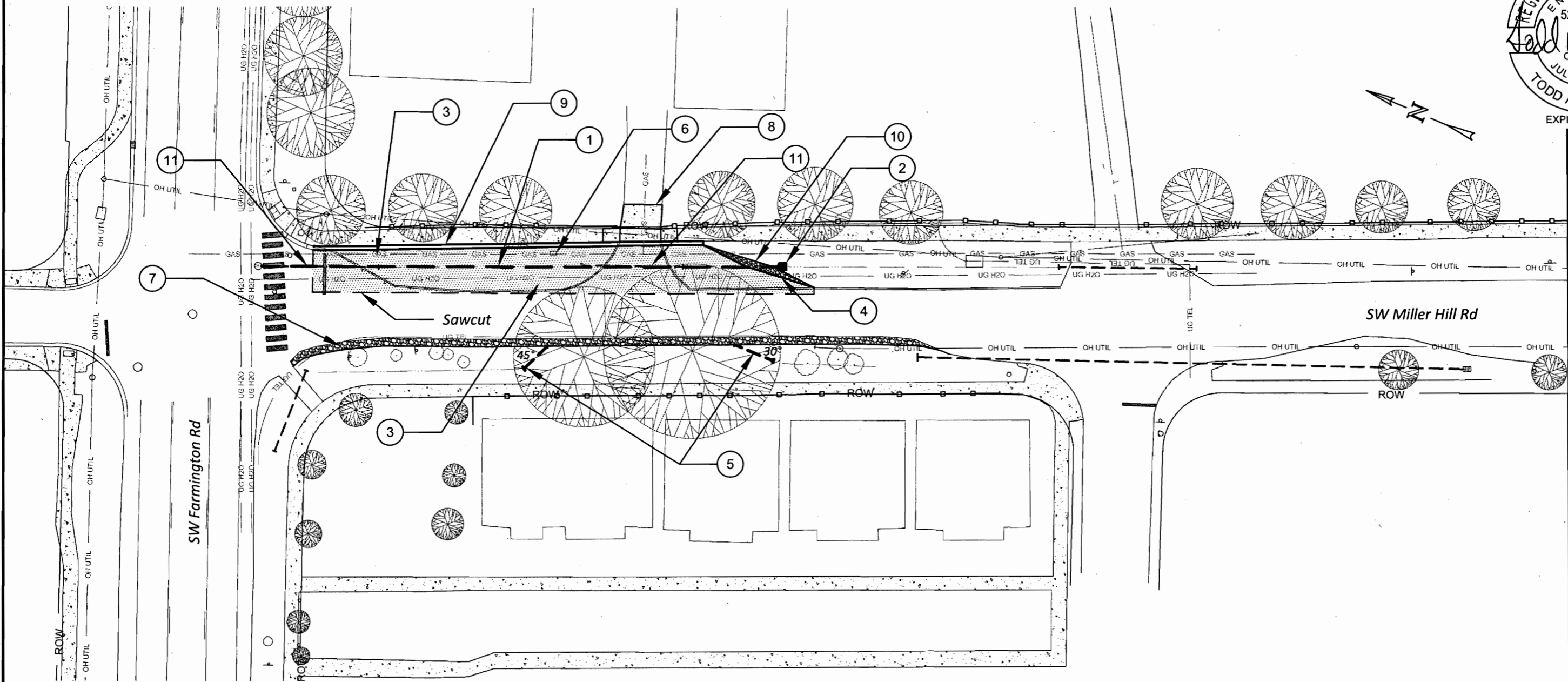

- ① Install 12" C 900 PCV Pipe - 200'. Connect To Existing Manhole At Same Elevation As Existing Pipe.
- ② Construct Ditch Inlet.
- ③ Construct Asphalt Concrete Pavement Widening.
- ④ Taper Pavement From New Gutter To Existing Asphalt.
- ⑤ Install 12" HDPE Pipe Extension Towards Existing Ditch Line. Build Up Shoulder, As Directed.
- ⑥ Adjust Box.
- ⑦ Construct 3' Shoulder. See Typical Sections.

- ⑧ Construct New Commercial Driveway Apron. See Wash. Co. Detail #1050.
- ⑨ Construct Curb And Gutter - 150'. See Wash. Co. Detail #2010.
- ⑩ Construct Aggregate Shoulder
- ⑪ Remove Existing Pipe (x2)

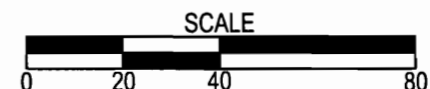

DEPARTMENT OF
LAND USE &
TRANSPORTATION
OPERATIONS

WASHINGTON COUNTY
OREGON

PLOT STAMP: 02/01/12 2:13P AARONC
CAD: FARMINGTON_MILLER_HILL.DWG, TAB: PLAN
DRAWN BY: D. DRAFTER

| NO. | REVISIONS |
|-----|-----------|
| | |
| | |

SW MILLER HILL ROAD
SW LUCAS OAKS LN. TO SW FARMINGTON RD.
WASHINGTON COUNTY

PROJECT NUMBER
7615
SHEET NO.
1 OF 3
SHEET TITLE
PROJECT 4

PLAN

Typical Section

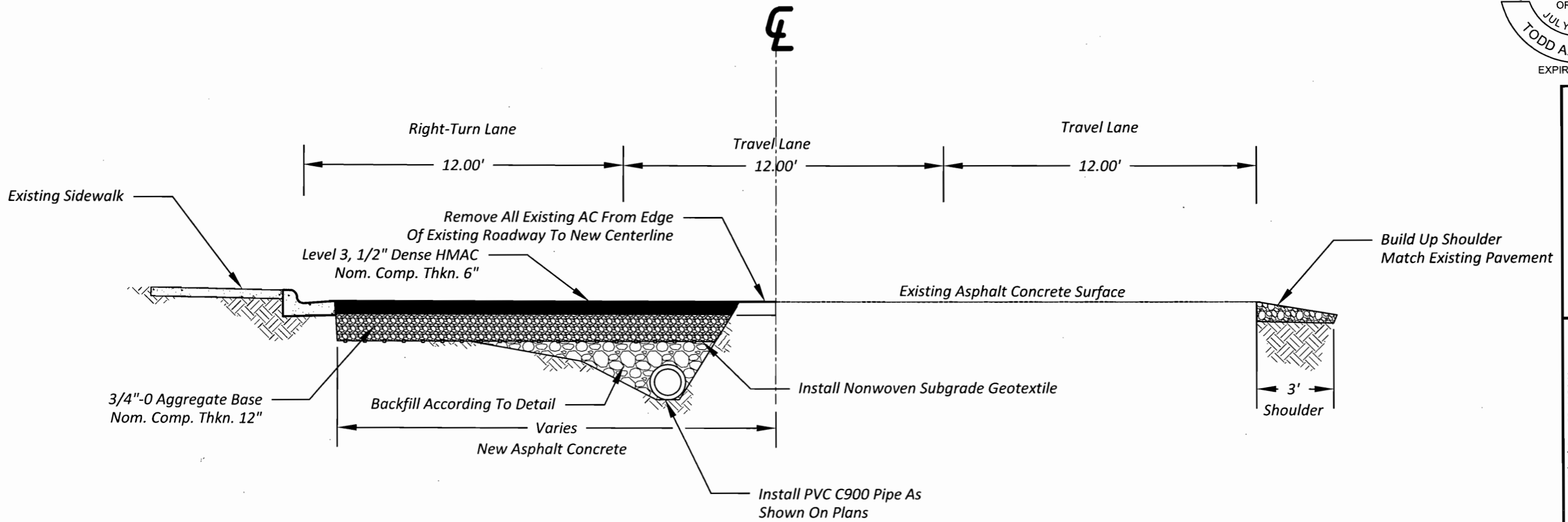

DEPARTMENT OF
LAND USE &
TRANSPORTATION
OPERATIONS

PLOT STAMP: 02/01/12 2:15P AARONG
CAD: FARMINGTON_MILLER_HILL.DWG, TAB: SECTION
DRAWN BY: D. DRAFTER

| NO. | REVISIONS |
|-----|-----------|
| | |
| | |
| | |

SW MILLER HILL ROAD
SW LUCAS OAKS LN. TO SW FARMINGTON RD.
WASHINGTON COUNTY

TYPICAL SECTION

PROJECT NUMBER
7615

SHEET NO.
2 OF 3

SHEET TITLE
PROJECT 4

SW MILLER HILL RD.

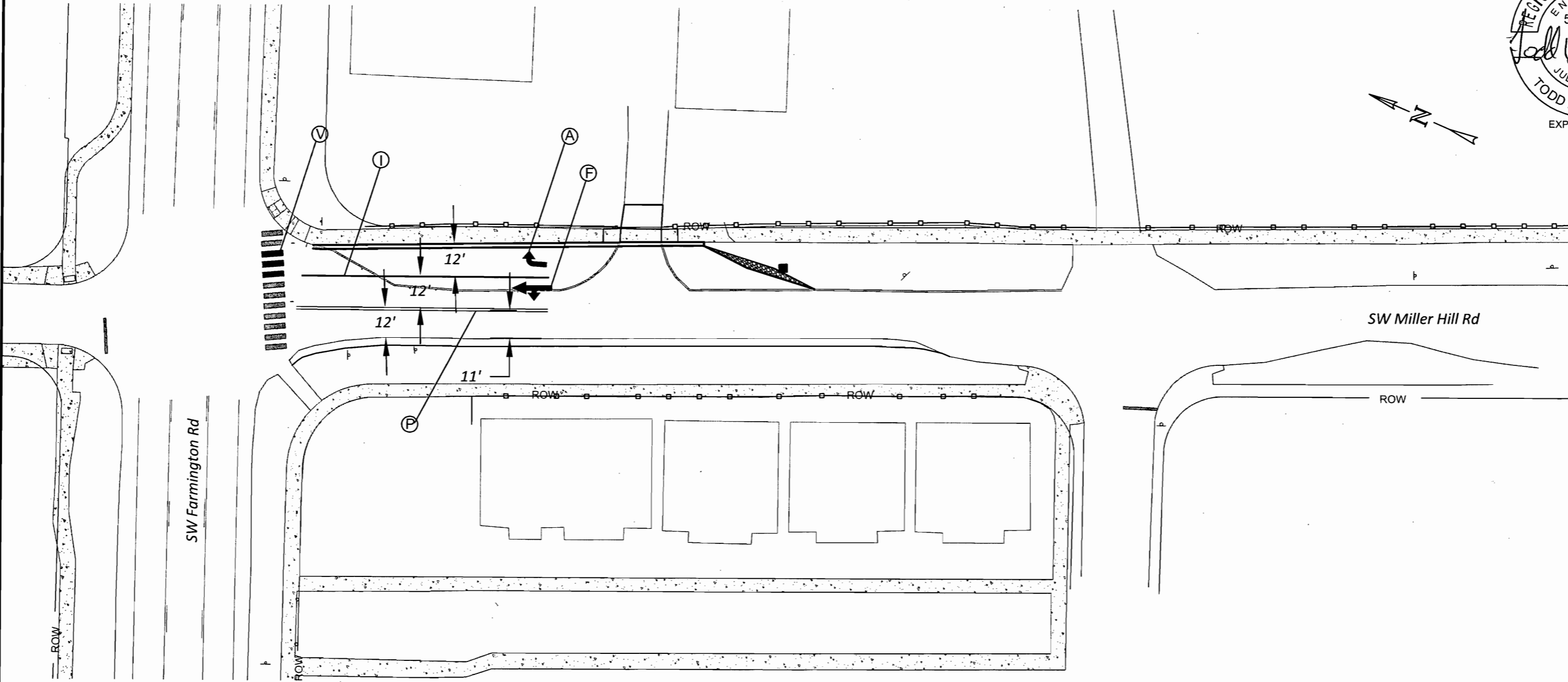
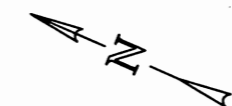

DEPARTMENT OF
LAND USE &
TRANSPORTATION
OPERATIONS



| | |
|--|-----------|
| PLOT STAMP: 02/01/12 2:13P AARONC | |
| CAD: FARMINGTON_MILLER_HILL.DWG, TAB: STRIPING | |
| DRAWN BY: D. DRAFTER | |
| NO. | REVISIONS |
| | |
| | |

SW MILLER HILL ROAD
SW LUCAS OAKS LN. TO SW FARMINGTON RD.
WASHINGTON COUNTY

STRIPING PLAN

PROJECT NUMBER
7615

SHEET NO.
3 OF 3

SHEET TITLE
PROJECT 4

Notes:

1. Striping Callout Letters Refer To Striping Legend As Shown In The Details.
2. Striping Layout Will Be Pre-Marked By Washington County.

